

- LEGEND**
- △ SECTION CORNER FOUND
 - 1/2"x24" REBAR SET W/ "KVE CLS-20" CAP
 - (GLO) DISTANCE PER GLO NOTES
 - (M) MEASURED BEARING AND DISTANCE

POINT OF BEGINNING

POINT OF COMMENCEMENT
SOUTHWEST CORNER, SECTION 4,
TOWNSHIP 19 SOUTH, RANGE 3 WEST,
MAG NAIL, ORIGIN UNKNOWN
ACCEPTED BY NICHOLAS D. SCHMIDT, PS 1492,
PER KSHS REFERENCE REPORT 239370

TRACT DESCRIPTION:
THAT PORTION OF THE SOUTHWEST QUARTER OF SECTION 4, TOWNSHIP 19 SOUTH, RANGE 3 WEST OF THE 6TH PRINCIPAL MERIDIAN IN THE COUNTY OF MCPHERSON, STATE OF KANSAS, BEING A PORTION OF THE PARCEL OF LAND DESCRIBED IN THE GENERAL WARRANTY DEED RECORDED IN BOOK 651 AT PAGE 6403 IN THE REGISTER OF DEEDS OFFICE AND BEING MORE PARTICULARLY DESCRIBED AS FOLLOWS:

ALL BEARINGS HEREON ARE BASED ON AN ASSUMED BEARING OF N 89°59'56" W ALONG THE SOUTH LINE OF SAID SOUTHWEST QUARTER COMMENCING AT THE SOUTHWEST CORNER OF SAID SECTION FOUR; THENCE ON THE SOUTH LINE OF SAID SOUTHWEST QUARTER S 89°59'56" E 667.60 FEET TO THE POINT OF BEGINNING; THENCE NORTH 00°00'04" EAST 718.00 FEET; THENCE S 89°59'56" E 1272.00 FEET; THENCE S 00°00'04" W 718.00 FEET TO SAID SOUTH LINE; THENCE ON SAID SOUTH LINE, N 89°59'56" W 1272.00 FEET TO THE POINT OF BEGINNING.

CONTAINING 20.97 ACRES AND SUBJECT TO ROAD RIGHT-OF-WAY EASEMENT ACROSS THE SOUTH 33.00 FEET THEREOF, AND ANY OTHER EASEMENTS OR RESTRICTIONS OF RECORD.

BASIS OF BEARINGS:
THE BASIS OF BEARINGS FOR THIS SURVEY IS AN ASSUMED BEARING OF N 89°59'56" W ALONG THE SOUTH LINE OF THE SOUTHWEST QUARTER OF SECTION 4, TOWNSHIP 19 SOUTH, RANGE 3 WEST, MCPHERSON COUNTY, KANSAS.

SURVEYOR'S CERTIFICATE:
STATE OF KANSAS }
COUNTY OF SALINA } SS

I, THE UNDERSIGNED, DO HEREBY CERTIFY THAT I AM A REGISTERED LAND SURVEYOR IN THE STATE OF KANSAS, WITH EXPERIENCE AND PROFICIENCY IN LAND SURVEYING; THAT THE HERETOFORE DESCRIBED PROPERTY WAS SURVEYED AND SUBDIVIDED BY ME, OR UNDER MY SUPERVISION; THAT ALL SUBDIVISION REGULATIONS OF THE COUNTY OF MCPHERSON, KANSAS HAVE BEEN COMPLIED WITH IN THE PREPARATION OF THIS PLAT; THAT THIS PLAT AND THE SURVEY ON WHICH IT IS BASED WERE MADE IN ACCORDANCE WITH THE KANSAS MINIMUM STANDARDS FOR BOUNDARY SURVEYS, AND THAT ALL THE MONUMENTS SHOWN HEREIN ACTUALLY EXIST AND THEIR POSITIONS ARE CORRECTLY SHOWN TO THE BEST OF MY KNOWLEDGE AND BELIEF.
GIVEN UNDER MY HAND AND SEAL AT SALINA, KANSAS, THIS 15 DAY OF January, A.D. 2021.

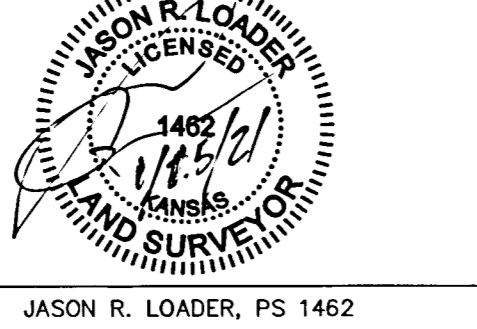

DATE OF SURVEY: NOVEMBER 4, 2020

OWNER'S CERTIFICATE:
STATE OF KANSAS }
COUNTY OF MCPHERSON } SS

THIS IS TO CERTIFY THAT BRUCE & MARLYS ELBERT FAMILY TRUST, OWN THE LAND DESCRIBED IN THE SOUTHWEST QUARTER OF SECTION 4, TOWNSHIP 19 SOUTH, RANGE 3 WEST OF THE 6TH PRINCIPAL MERIDIAN IN THE COUNTY OF MCPHERSON STATE OF KANSAS AND HAVE CAUSED THE SAME TO BE SURVEYED AND SUBDIVIDED AS INDICATED THEREON, FOR THE USES AND PURPOSES THEREIN SET FORTH AND DOES HEREBY ACKNOWLEDGE AND ADOPT THE SAME UNDER THE STYLE AND TITLE THEREON INDICATED.

AN EASEMENT OR LICENSE TO THE PUBLIC TO LOCATE, CONSTRUCT AND MAINTAIN OR AUTHORIZE THE LOCATION, CONSTRUCTION AND MAINTENANCE OF POLES, WIRES, CONDUITS, WATER, GAS AND SEWER PIPES OR REQUIRED DRAINAGE CHANNELS OR STRUCTURES UNDER OR UPON THE AREAS MARKED FOR EASEMENTS ON THIS PLAT IS HEREBY GRANTED.
THIS SUBDIVISION SHALL HEREAFTER BE KNOWN AS "ELBERT SUBDIVISION".

GIVEN UNDER MY HAND AT Salina, KANSAS, THIS 18th DAY OF January, A.D. 2021.

Bruce A. Elbert
BRUCE A. ELBERT

Marlys C. Elbert
MARLYS C. ELBERT

NOTARY CERTIFICATE:
STATE OF KANSAS }
COUNTY OF MCPHERSON } SS

I, Carol J. Bell, A NOTARY PUBLIC IN AND FOR SAID COUNTY, IN THE STATE AFORESAID, DO HEREBY CERTIFY THAT BRUCE A. ELBERT AND MARLYS C. ELBERT, ARE KNOWN TO ME TO BE THE SAME PERSON WHOSE NAME IS SUBSCRIBED TO THE FOREGOING INSTRUMENT AS SUCH OWNER, APPEARED BEFORE ME THIS DAY IN PERSON AND ACKNOWLEDGED THAT HE SIGNED AND DELIVERED THE PLAT AS THE FREE AND VOLUNTARY ACT OF SAID CORPORATION FOR THE USES AND PURPOSES THEREIN SET FORTH.

GIVEN UNDER MY HAND AND NOTORIAL SEAL THIS 18th DAY OF January, A.D. 2021.

Carol J. Bell
CAROL J. BELL
Notary Public - State of Kansas
My Appt. Expires 12-11-2023

REVIEW SURVEYOR'S CERTIFICATE:
STATE OF KANSAS }
COUNTY OF MCPHERSON } SS

REVIEWED IN ACCORDANCE WITH K.S.A. 58-2005 ON THIS THIS 26th DAY OF February, 2021.

William B. Heller, Ps. 1202
WILLIAM B. HELLER
MCPHERSON COUNTY SURVEYOR

MORTGAGE HOLDER CERTIFICATE:
STATE OF KANSAS }
COUNTY OF MCPHERSON } SS

WE, _____, BY _____, EXECUTIVE VISE PRESIDENT, HOLDERS OF A MORTGAGE ON THE ABOVE DESCRIBED PROPERTY DO HEREBY CONSENT TO THE PLAT OF "ELBERT SUBDIVISION, MCPHERSON COUNTY, KANSAS"

GIVEN UNDER MY HAND AT _____, KANSAS, DATED THIS _____ DAY OF _____, A.D. 2021.

PRESIDENT
BANK

PLANNING COMMISSION CERTIFICATE:
STATE OF KANSAS }
COUNTY OF MCPHERSON } SS

APPROVED BY MCPHERSON COUNTY PLANNING COMMISSION ON THIS 26th DAY OF February, A.D. 2021.

Tim Bornholdt
TIM BORNHOLDT, CHAIRMAN

ATTEST: John Verssue
JOHN VERSSUE, SECRETARY

REGISTER OF DEEDS CERTIFICATE:
STATE OF KANSAS }
COUNTY OF MCPHERSON } SS

PLAT OF ELBERT SUBDIVISION, FILED OF RECORD IN MY OFFICE ON THIS 1 DAY OF March, A.D. 2021, AT 10:11 AM, AND DULY RECORDED IN VOLUME LC OF PLATS, AT PAGE 64.

FILING FEE OF 32.00 PAID.

Laurie B. Wizarde, Register of Deeds
McPherson County, Kansas
Book: LC Page: 65
Receipt #: 217074 Total Fees: 332.00
Pages Recorded: 1
Clerk Initials: Hollis Author: Jason Loader

Date Recorded: 3/1/2021 10:11:49 AM

TRANSFER RECORD:
ENTERED ON TRANSFER RECORD THIS 1 DAY OF March, A.D. 2021.

Hollie D. Melroy
HOLLIE D. MELROY, COUNTY CLERK

GOVERNING BODY CERTIFICATE:
STATE OF KANSAS }
COUNTY OF MCPHERSON } SS

THE DEDICATIONS SHOWN ON THE PLAT, IF ANY, ARE HEREBY ACCEPTED BY THE BOARD OF COUNTY COMMISSIONERS OF MCPHERSON COUNTY, KANSAS ON THIS 22nd DAY OF February, A.D. 2021.

Keith Becker
KEITH BECKER, COMMISSIONER

Tom Kueser
TOM KUESER, COMMISSIONER

David O'Dell
DAVID O'DELL, COMMISSIONER

ATTEST: Hollie D. Melroy
HOLLIE D. MELROY, COUNTY CLERK

COUNTY CLERK CERTIFICATE:
STATE OF KANSAS }
COUNTY OF MCPHERSON } SS

I, Hollie D. Melroy, COUNTY CLERK OF MCPHERSON COUNTY, KANSAS WITHIN MY RESPECTIVE JURISDICTIONS, DO HEREBY CERTIFY THAT AT THE DATE OF THIS CERTIFICATE, ALL CURRENTLY DUE AND OWNING TAXED AND SPECIAL ASSESSMENTS OF ANY KIND ASSESSED AGAINST ANY OF THE LAND INCLUDED IN THIS PLAT HAVE BEEN PAID ON THIS 1 DAY OF March, A.D., 2021.

Hollie D. Melroy
HOLLIE D. MELROY, COUNTY CLERK

FINAL PLAT OF
ELBERT SUBDIVISION
MCPHERSON COUNTY, KANSAS

A TRACT IN THE SOUTHWEST QUARTER OF SECTION 4, TOWNSHIP 19 SOUTH, RANGE 3 WEST OF THE 6TH P.M., MCPHERSON COUNTY, KANSAS

KAW VALLEY ENGINEERING, INC.
742 DUVALL AVENUE
SALINA, KANSAS 67401
PH. (785) 823-3400 | FAX (785) 823-3411
sa@kveng.com | www.kveng.com

DATE OF PREPARATION: JANUARY 14, 2021
PROJECT NO. E20S2684 SHEET 1 OF 1